

N=Number of contacts

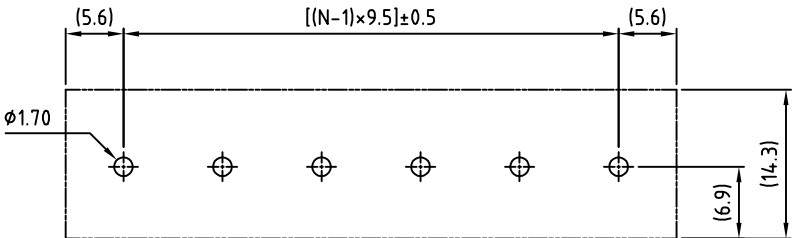
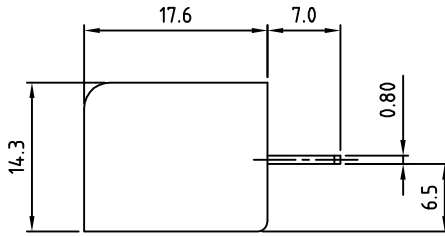
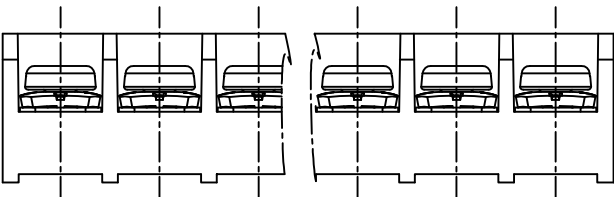

PCB Layout

SIGN	DATE	DESCRIPTION	APPROVER
THIS IS CAD DRAWING, DO NOT REVISE MANUALLY!!!			

**MATERIALS**

**ELECTRICAL**

VOLTAGE & CURRENT: 300V, 25 A

WITHSTANDING VOLTAGE: AC 2000 V/Min

INSULATION RESISTANCE: 1000 MΩ OR MORE AT DC 500 V

TEMPERATURE RANGE: -40 °C ~ +105 °C

SCREW TORQUE VALUE: 10.54 Lb-In.

WIRE RANGE: 22 - 14 AWG

1) MOLDED PARTS: POLYIMIDE 66, UL 94 V-0 BLACK

2) TERMINAL: BRASS, 0.8t, Tin PLATED

3) TERMINAL SCREWS: STEEL, Ni PLATED, M3.5

APPROVAL:

PART NUMBER:  
**OSTYK442XX030**

No. of Poles

02: 2 Poles

03: 3 Poles

04: 4 Poles

...

30: 30 Poles



THESE DRAWINGS AND SPECIFICATIONS ARE THE PROPERTY OF ON-SHORE TECHNOLOGY, INC. AND SHALL NOT BE REPRODUCED, COPIED OR USED IN ANY MANNER WITHOUT THE PRIOR WRITTEN CONSENT OF ON-SHORE TECHNOLOGY, INC.

TITLE		OSTYK-442 Series				
PART NO.	OSTYK442XX030	DWG NO.	OSTYK442XX030.DWG			
APPROVED	CHECKED	DESIGNED	DRAWN	CUST NO.	Tolerance	
Shi Jun 2006.11.07	Seamus 2006.11.06	Steady 2006.10.20	Steady 2006.10.20		X. ±0.50	
					UNIT: mm	X.X ±0.30
				SHEET: 01/01	SCALE: NONE	X.XX ±0.10
				REV: D	X° ±1°	